

82'-4"

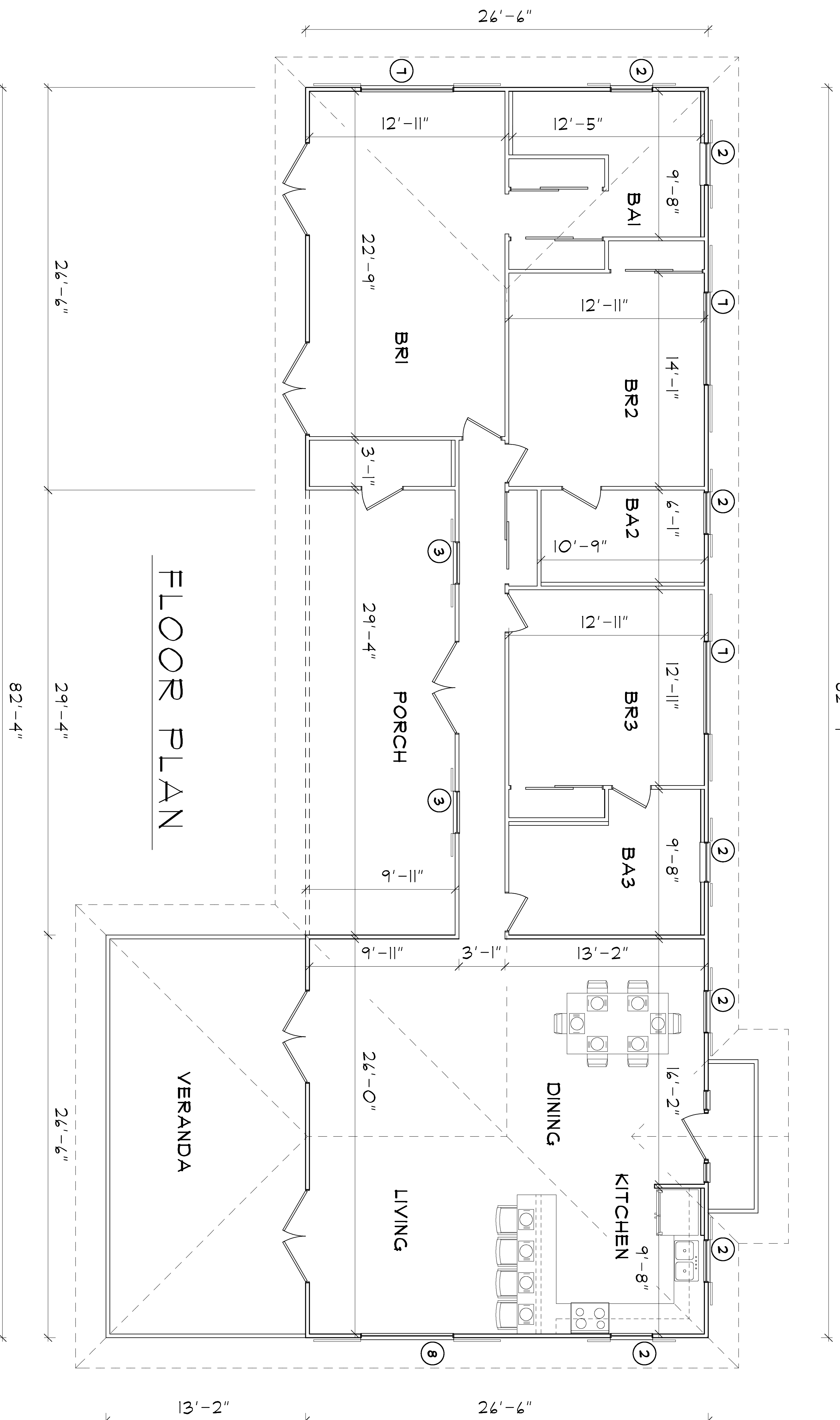

FLOOR PLAN

PLAN: ADAMS

FORCE IO ENGINEERED BUILDING SYSTEM

- Hurricane & Earthquake Resistant
- Fire, Rot & Mildew Resistant
- Insulated Walls & Roof for Energy Efficiency
- High Quality, Low Maintenance Materials
- Custom Designed Floor Plans for any Site

Force IO Floor System:

Pre-cut & pre-drilled galvanized steel joists and bearers bolted to galvanized steel columns which are cast into concrete footings. Fibercement-board, particle-board, plywood subfloor or hardwood

Force IO Wall Panel System:

3" thick galvanized steel and fibercement-board stress skin panels with fire-retardant polyurethane foam in wall cavity (R18). Wall panel is bolted to Force IO floor system (or concrete floor slab) with galvanized steel hex head bolts at 39" on center.

Force IO Roof System:

Pre-cut & pre-drilled galvanized steel roof truss components are assembled quickly on site and secured to panels with galvanized steel bolts at 39" on center. Galvanized steel purlins and pre-painted Galvalume roof sheathing are screwed to trusses. Pre-painted Galvalume fascia and gutter, radiant barrier insulation & fibercement-board soffits are supplied to complete the roof.

INNOVATIVE BUILDERS

www.force-10.com info@force-10.com
 BOX 305071, ST. THOMAS, VI 00803
 TEL: 340-690-2175 force-10@earthlink.net

CALCULATIONS

Ground Fl.	Interiors	Roof
Veranda	1892 Square Feet	3078 Square Feet
Porch	348 Square Feet	
Entry Deck	288 Square Feet	
TOTAL	33 Square Feet	2561 Square Feet

WINDOW SCHEDULE

Symbol	Type	Size	Notes	Supplier
2	Double Hung	2/8 X 3/0	Screen	Force IO
3	Double Hung	2/8 X 4/0	Screen	Force IO
1	Double Hung	6/0 X 3/0	Screen	Force IO
8	Double Hung	6/0 X 4/0	Screen	Force IO

